



ACURA

**INSTALLATION
INSTRUCTIONS**

Accessory	Application	Publications No.
AUTOMATIC DAY/NIGHT MIRROR		BII 32616
		Issue Date JULY 2006

PARTS LIST

**Automatic Day/Night Mirror Kit
P/N 08V03-STK-200A**

Day/Night mirror

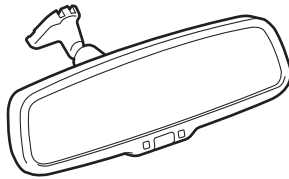

Accessory user's information manual

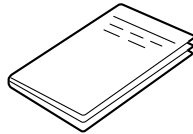

**Automatic Day/Night Mirror Attachment Kit
P/N 08V03-STK-200**

Mirror harness

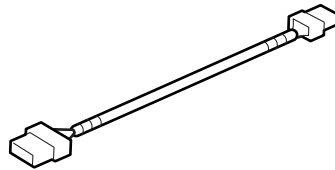

Template

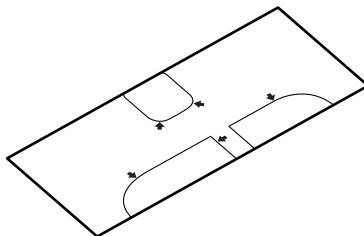

2 Wire ties

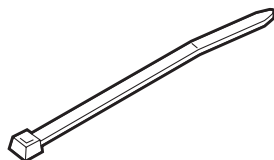

Cover

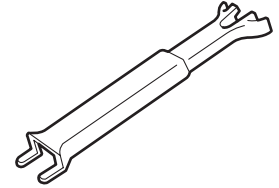

Cover base

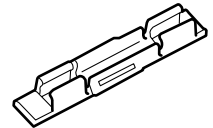

3 EPT sealers

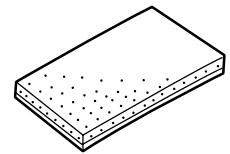

Clip

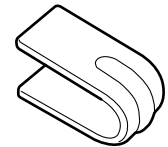
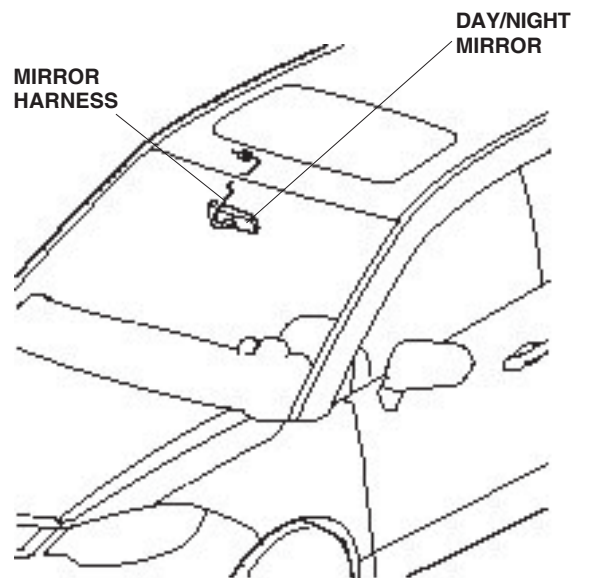

Illustration of the Day/Night Mirror Installed on the Vehicle



TOOL AND SUPPLIES REQUIRED

Phillips screwdriver
KTC trim tool set P/N SOJATP2014
Ratchet
8 mm Socket
Isopropyl alcohol
Shop towel
Scale
Diagonal cutters
Scissors
Tape
T20 TORX bit
Small plastic hammer

INSTALLATION

Customer Information: The information in this installation instruction is intended for use only by skilled technicians who have the proper tools, equipment, and training to correctly and safely add equipment to your vehicle. These procedures should not be attempted by “do-it-yourselfers.”

1. Make sure you have the anti-theft code for the radio, then write down radio station presets.
2. Disconnect the negative cable from the battery.
3. Using a plastic trim tool wrapped with a shop towel, remove the map light (two retaining tabs and one clip, and unplug the two vehicle connectors).

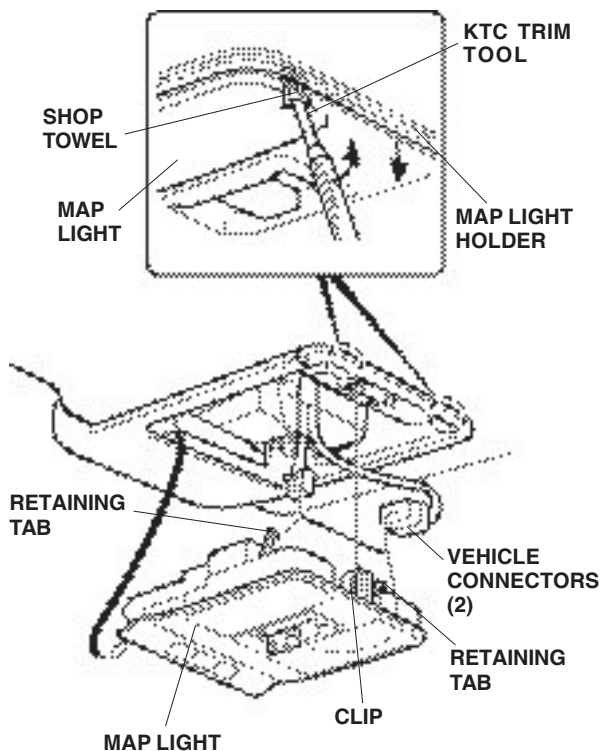

4. Remove the map light holder (four bolts).

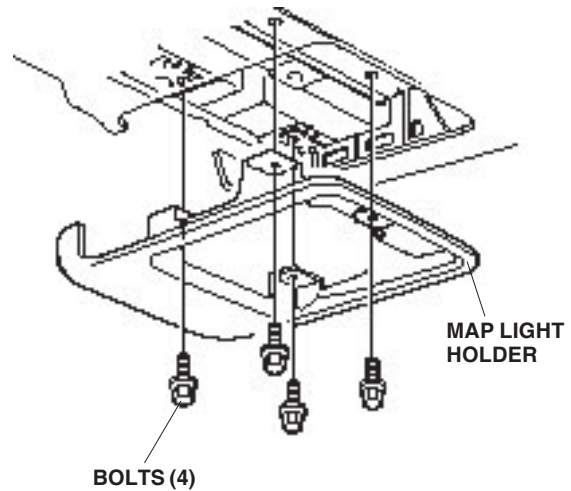

5. Remove the mirror by gently tapping the the mirror base with a small plastic hammer. Set the mirror aside it will not be reused.

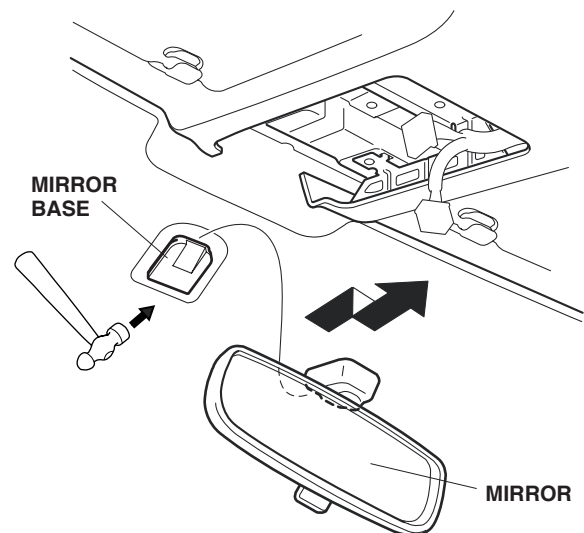

- Using scissors, cut out the template as shown.

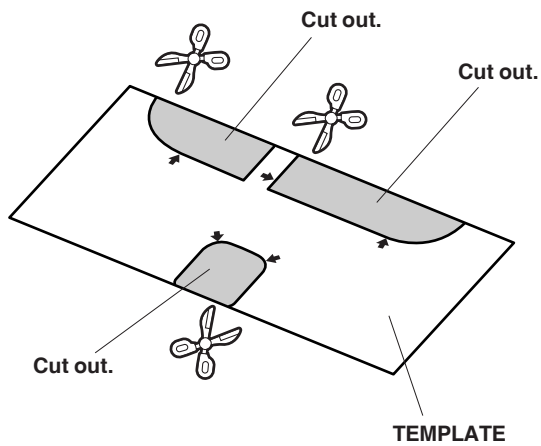

- Using isopropyl alcohol on a clean shop towel clean the inside upper center portion of the front windshield surface where the cover base will attach. Tape the template to the front windshield in the location shown.

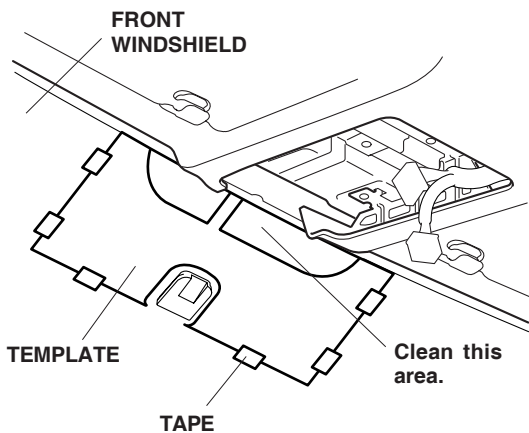

- Remove the adhesive backing from the cover base and attach the cover base to the front windshield.

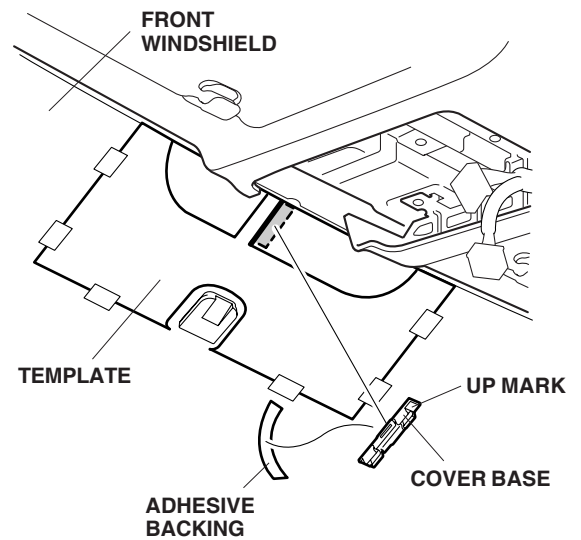

- Remove the template.
- Using scissors cut one EPT sealer in half. Attach one half of the EPT sealers to the edge of the vehicle panel. The remaining half will be used later.
- Plug the mirror harness 7-pin connector into the day/night mirror.

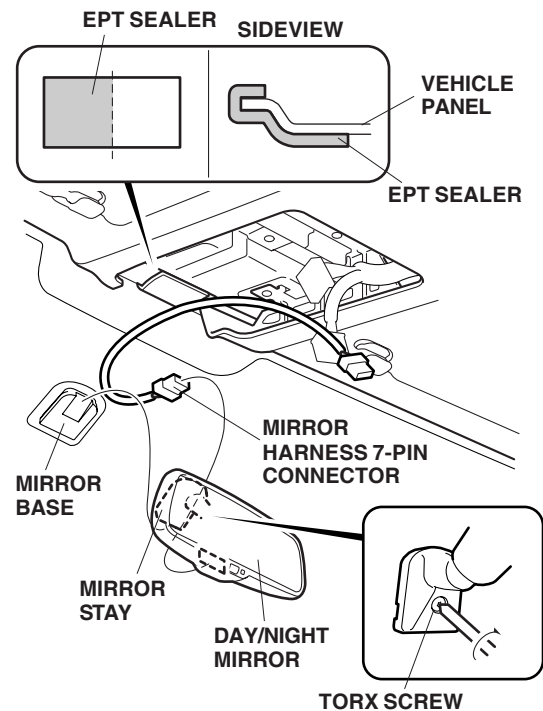

- Slide the day/night mirror onto the mirror base, and tighten the T20 TORX screw.

13. Push the mirror harness into the cover base. Get the clip and attach the mirror harness to the day/night mirror arm using the clip.

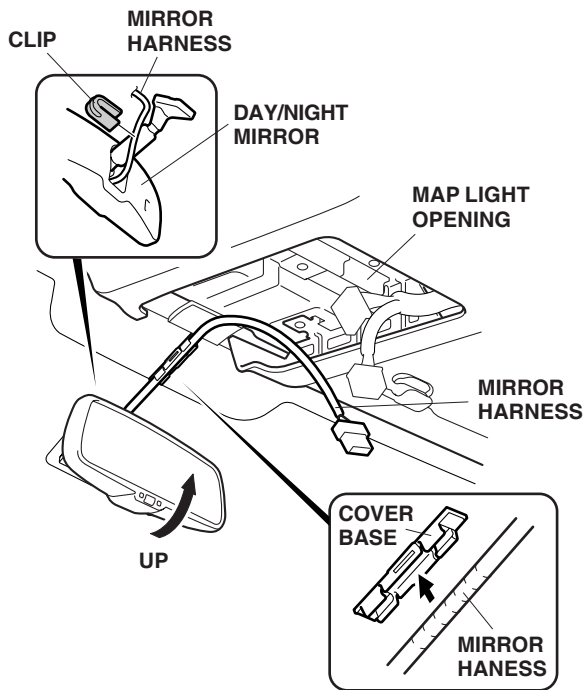

14. Plug the mirror harness 4-pin connector into the vehicle 4-pin connector.

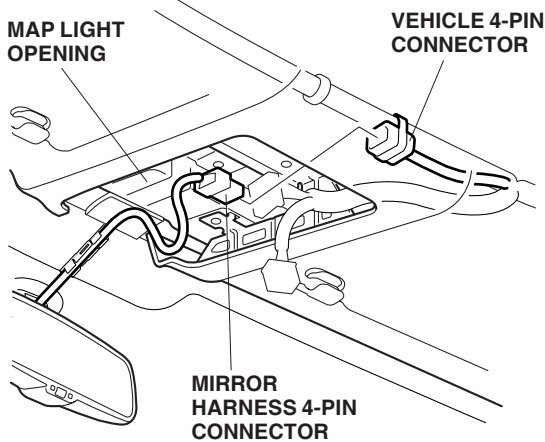

15. Secure the mirror harness to the vehicle harness using two wire ties.

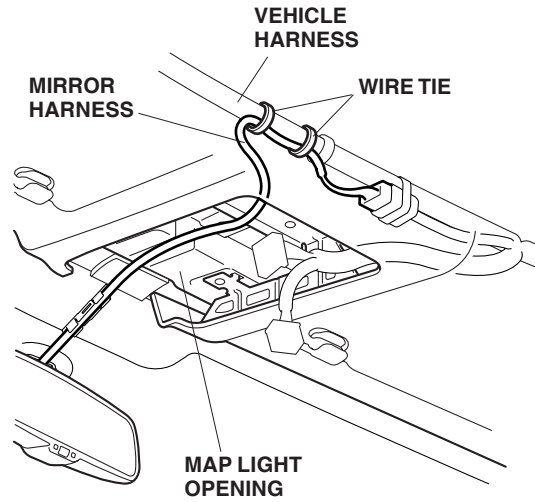

16. Measure and cut one EPT sealer to 80 mm. The remaining 40 mm portion will be used later.

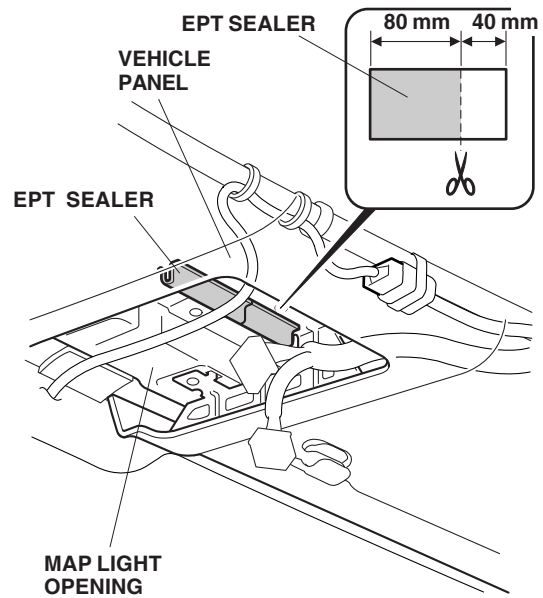

17. Using isopropyl alcohol on a shop towel, clean the vehicle panel surface where the EPT sealer will attach. Attach one complete EPT sealer then attach the 80 mm piece of EPT sealer to the edge of the vehicle panel to cover the entire edge.

18. Using isopropyl alcohol on a clean shop towel, clean the vehicle panel surface where the EPT sealer will attach. Secure the mirror harness to the vehicle panel using one half of EPT sealer.

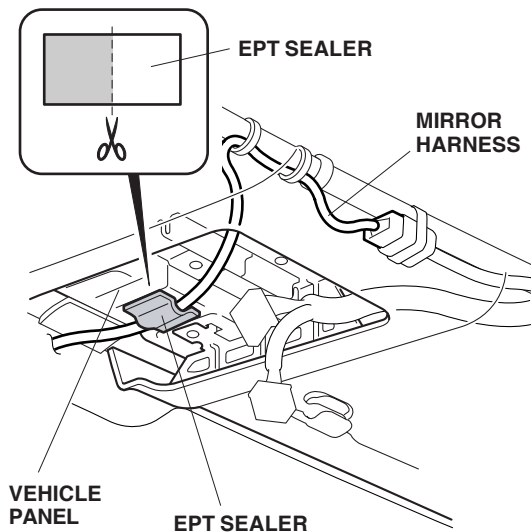

19. Install the cover to the cover base. Clip the bottom into the mirror base, then slide the top of the cover up under the roof frame.

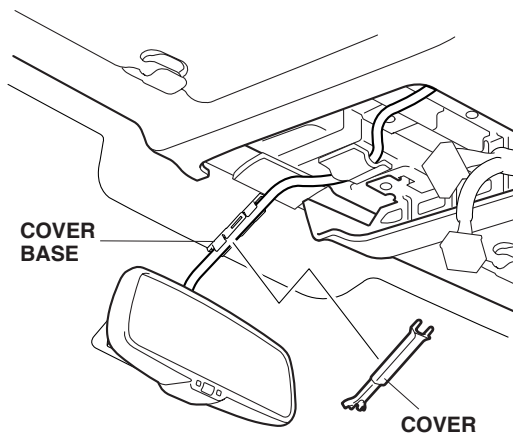

21. Using isopropyl alcohol on a clean shop towel, clean the front windshield and the cover surface where the EPT sealer will attach. Secure the cover and cover base using the 40 mm piece of EPT sealer from step 6.

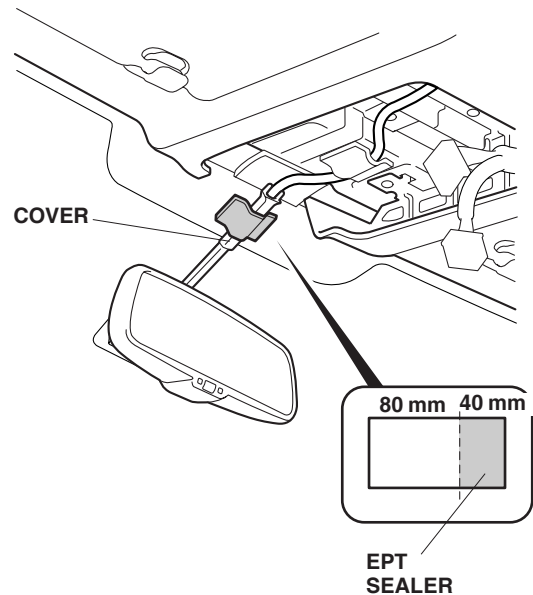

21. Check that all wire harnesses are routed properly and all connectors are plugged in.
22. Reinstall all removed parts.
23. Reconnect the negative cable to the battery.
24. Enter the customer's radio anti-theft code, and reset the radio station presets.
25. Reset the clock.
26. If equipped, check operation of the security system according to the security system Operating instructions provided.

NOTE: Check the operation of the automatic day/night mirror according to the Accessory user's information manual supplied.

NOTE: When the battery is disconnected, the driver's window AUTO function is disabled.

- Start the engine. Push down on the driver's window switch until the window is fully open.
- Pull up on the driver's window switch to close the window completely, then hold the switch for 2 seconds or more.
- Lower and raise the driver's window to check operation of the driver's window AUTO function.